

Bridge fitting

TYPE:BE-B1

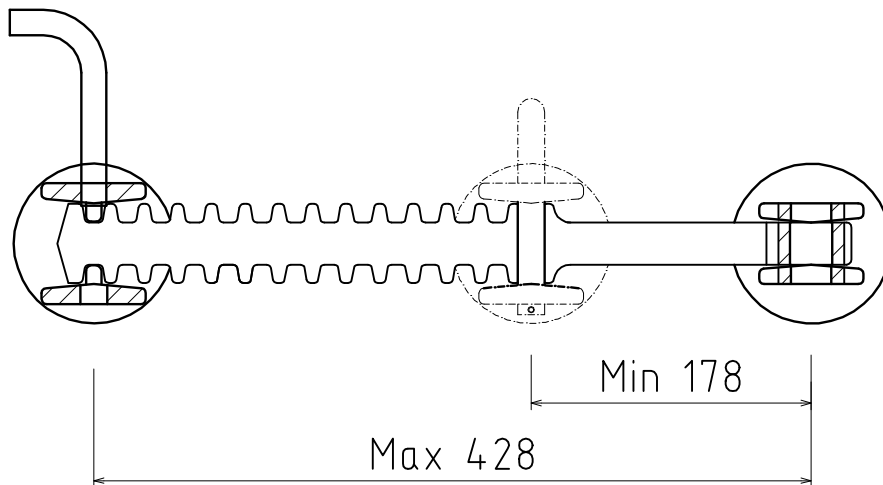
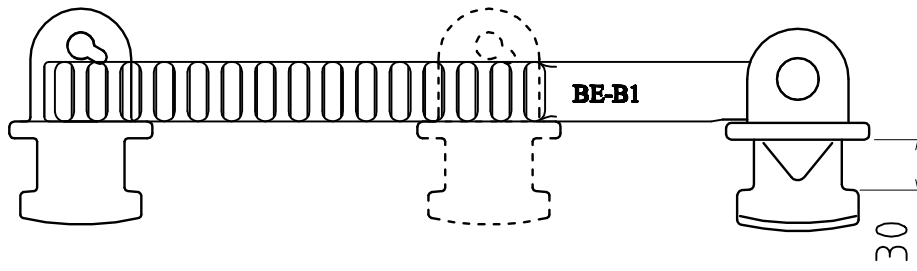

Material: Made of casting steel
Finish: Hot dip galvanised
Weight: 8.0KG

M.B.L:Tension: 300KN
M.B.L:Shear: -
M.B.L:Compression: -

General Lashing System(China)Co.,Ltd.

[Http://www.Generallashing.com](http://www.Generallashing.com)